

## RING IN SOUTACHE WITH PURECRYSTAL CABOCHON AND HEMATITE

By : Julie



Easy



2h

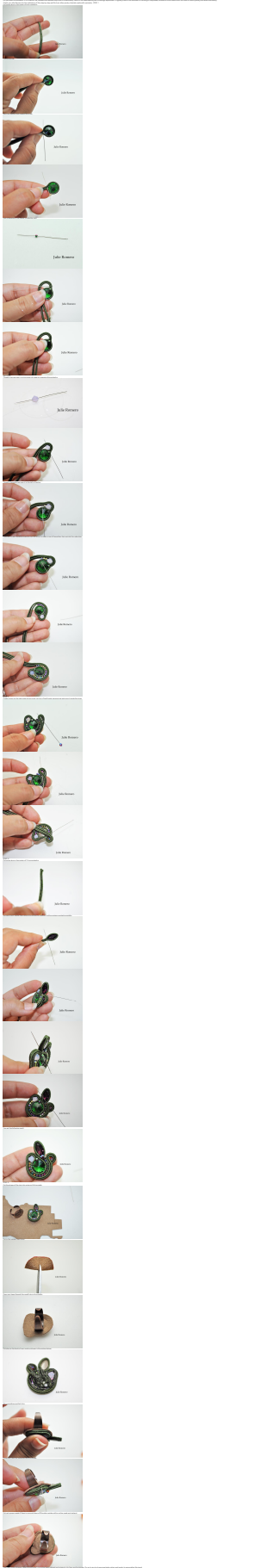

*Which material to use for Ring in soutache with PureCrystal cabochon and hematite?*

## SUPPLIES



Filigreed ring base 19mm Old copper tone  
Ref. : BAGUE-014  
Quantity : 1



Fireline braided Nylon thread 0.12 mm (6LB) Crystal x45 m  
Ref. : BRF-116  
Quantity : 1



Soutache Made in France 3,5mm Dark Green x5 m  
Ref. : FC-483  
Quantity : 1



John James Beading needle Size 13 49 mm x25  
Ref. : OAC-107  
Quantity : 1



Ultra Suede scraps 21.5x21.5cm Chamois x1  
Ref. : OAC-1139  
Quantity : 1



Jewel Glue Hasulith 30ml  
Ref. : OUTIL-007  
Quantity : 1



Mini-beads imitation hematite faceted cubes 2mm Iris x40cm  
Ref. : SP-631  
Quantity : 1



PureCrystal 1122 Rivoli Round Stone 12mm Emerald Foiled x1  
Ref. : SWC-868  
Quantity : 1



PureCrystal Crystal Bicones 4mm Siam AB2X x50  
Ref. : TPK-493  
Quantity : 1



PureCrystal Crystal Bicones 6mm Violet Opal x20  
Ref. : TPK-811  
Quantity : 1



PureCrystal 1122 Rivoli Round Stone 12mm Dark Moss Green x1  
Ref. : WCB-1634  
Quantity : 1



PureCrystal Navette 15x7mm Amethyst  
Ref. : WNV-096  
Quantity : 1

*Result*